



Chamberlayne Road, Kensal Rise, NW10

£469,950



Chamberlayne Road, Kensal Rise, NW10

A perfectly located, bright and well presented one bedroom apartment positioned on the fourth floor (with lift) of a modern building benefiting from access to a stunning communal roof terrace.

This flat would make an ideal first time purchase and further benefits from a fully fitted kitchen, contemporary bathroom and a spacious open plan kitchen/reception.

Chamberlayne Road is perfectly positioned with both Kensal Green station (Bakerloo Line & overground) and Kensal Rise station (overground) situated close by along with Queens Park station (overground). Furthermore, local amenities, restaurants and bars can be found just yards away

Features

- Stunning Communal Roof Terrace
- One Bedroom
- Fourth Floor (With Lift)
- Perfect Location
- Modern Building
- Contemporary Fully Fitted Kitchen
- Stylish Bathroom
- Bright & Well Presented
- Ideal First Time Purchase



Chamberlayne Road,
Kensal Rise, NW10

Chamberlayne Road, NW10

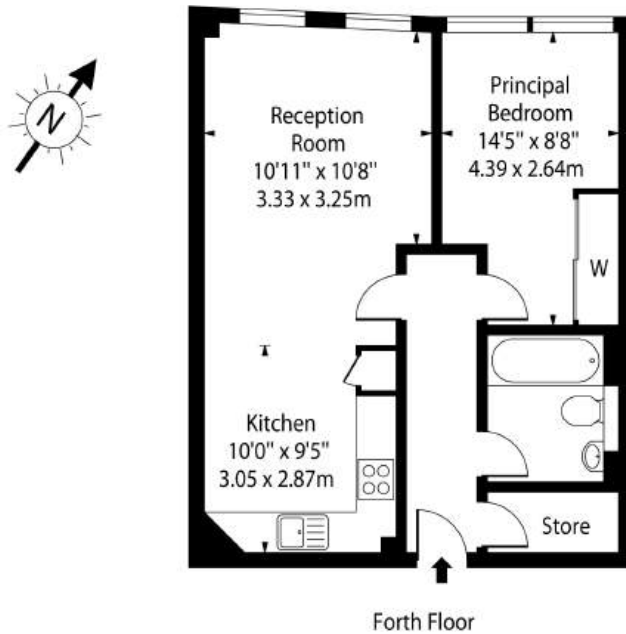

Approx Gross Internal Area 528 Sq Ft - 49.05 Sq M

For Illustration Purposes Only - Not To Scale Floor Plan by www.nogaphotostudio.com Ref: No.41178

This floor plan should be used as a general outline for guidance only. Any intending purchaser or lessee should satisfy themselves by inspection, searches, enquiries and full survey as to the correctness of each statement. Any areas, measurements or distances quoted are approximate and should not be used to value a property or be the basis of any sale or let.