



## Holmdale Mansions, Holmdale Road, West Hampstead, NW6

£2,500  
pcm



## Holmdale Mansions, Holmdale Road, West Hampstead, NW6

A recently refurbished two bedroom apartment with a private courtyard area situated in the heart of West Hampstead.

This ground floor flat has been modernised to the highest of standards and includes a contemporary fully fitted kitchen, a stylish bathroom, spacious reception room and a generous principal bedroom with ample built in storage.

Holmdale Mansions is perfectly located within in the centre of West Hampstead and just 0.4 miles from the the local amenities, restaurants and transport links that West End Lane has to offer.

\*NB The landlord of this property is related to a member at YRT Residential Limited.

### Features

- Recently Refurbished
- Two Bedroom
- Stylish Bathroom
- Contemporary Fully Fitted Kitchen
- Located In The Heart Of West Hampstead
- Unfurnished
- Spacious Reception Room
- Generous Principal Bedroom
- Private Courtyard Area
- Available Late January 2025



Holmdale Mansions,  
Holmdale Road, West  
Hampstead, NW6

Holmdale Mansions,  
Holmdale Road, NW6

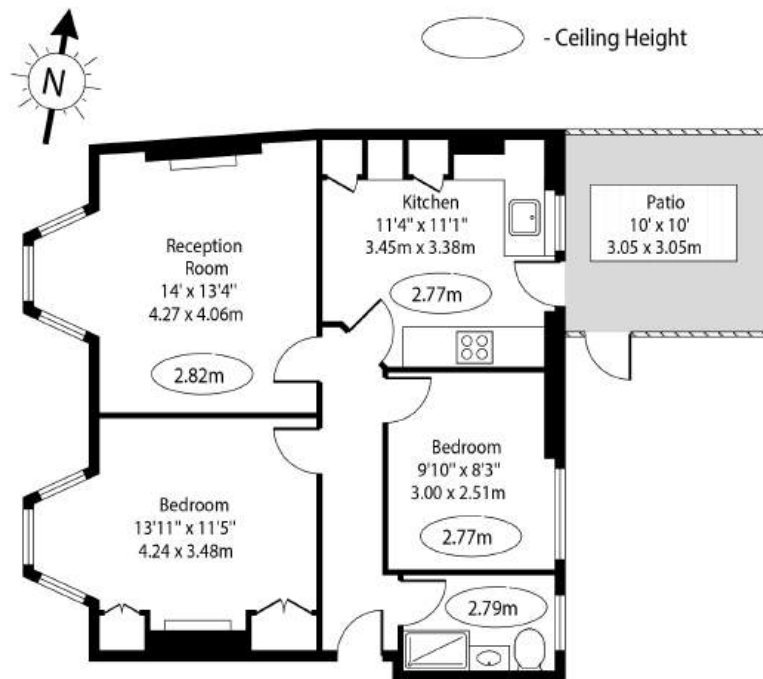

Ground Floor

Approx Gross Internal Area 600 Sq Ft - 55.74 Sq M

For Illustration Purposes Only - Not To Scale Floor Plan by [www.nogaphotostudio.com](http://www.nogaphotostudio.com) Ref: No.48664

This floor plan should be used as a general outline for guidance only. Any intending purchaser or lessee should satisfy themselves by inspection, searches, enquiries and full survey as to the correctness of each statement. Any areas, measurements or distances quoted are approximate and should not be used to value a property or be the basis of any sale or let.