



**Glenloch Road, Belsize Park, NW3**

£2,800  
pcm



## Glenloch Road, Belsize Park, NW3

An impressive and well presented two double bedroom first floor apartment located in the heart of Belsize Park with benefits including a balcony.

This fine flat offers circa 700 sq ft (65 Sq M) of internal space including an expansive reception with direct access to a balcony, a modern fully fitted kitchen, two double bedrooms with generous storage space and a bathroom.

Glenloch Road is perfectly positioned just off Haverstock Hill with both Belsize Park underground station (Northern line) and the local amenities situated just yards away.

### Features

- Located Less Than 250 Ft From Belsize Park Underground Station
- Two Double Bedrooms
- First Floor Apartment
- Impressive Flat
- Stunning Reception Room
- Available From Mid-January 2024
- Balcony
- Situated In The Heart Of Belsize Park
- Offered Unfurnished



Glenloch Road,  
Belsize Park, NW3

Glenloch Road, NW3 4BX

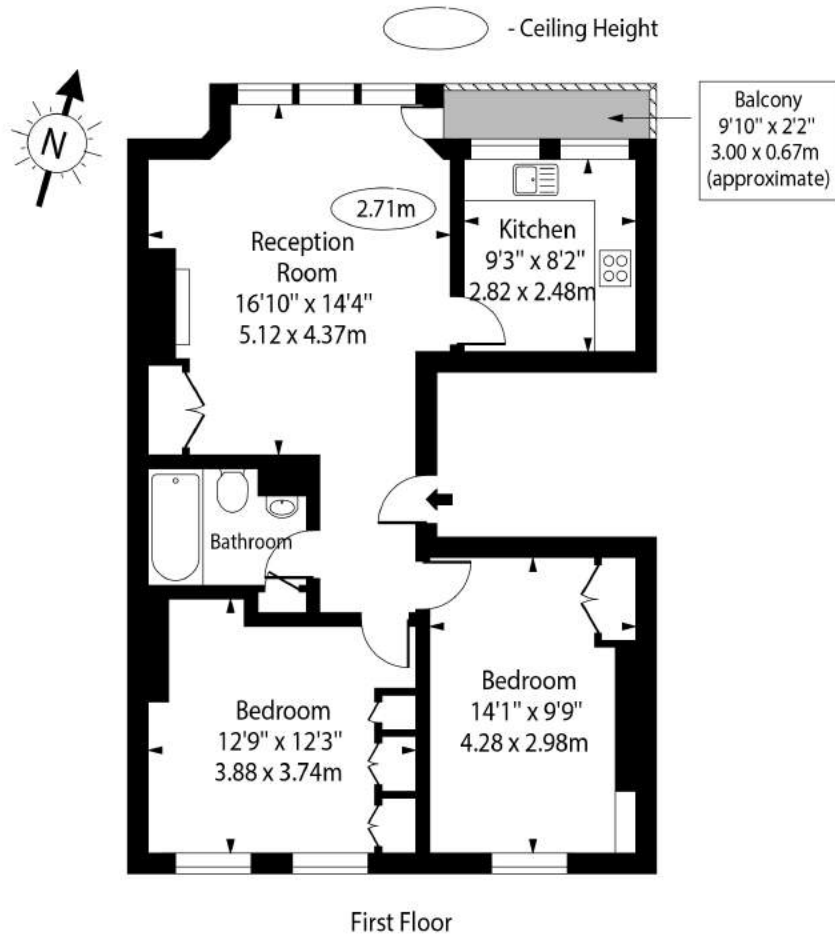

Approx Gross Internal Area 694 Sq Ft - 64.44 Sq M

For Illustration Purposes Only - Not To Scale Floor Plan by [www.nogaphotostudio.com](http://www.nogaphotostudio.com) Ref: No.48431

This floor plan should be used as a general outline for guidance only. Any intending purchaser or lessee should satisfy themselves by inspection, searches, enquiries and full survey as to the correctness of each statement. Any areas, measurements or distances quoted are approximate and should not be used to value a property or be the basis of any sale or let.