



Allingham Court, Haverstock Hill, Belsize Park, NW3

£850,000



Allingham Court, Haverstock Hill, Belsize Park, NW3

Situated in the heart of Belsize Park is this generously sized three bedroom apartment found on the third floor (with lift) of a traditional purpose built building.

Offering 1034 Sq Ft (96 Sq M) of internal space, this character filled apartment boasts three double bedrooms, a spacious reception room, ample dining space and a fully fitted kitchen. Further benefits include a separate WC, an abundance of storage throughout, double glazing and a recently renewed lease.

Allingham Court is perfectly located moments from the local amenities on Haverstock Hill with Belsize Park underground station (Northern Line) just 150 ft away. Both Primrose Hill & Hampstead Heath are situated within easy reach as well.

*Please note that virtual furniture is included within the marketing photos.

Features

- Situated In The Heart Of Belsize Park
- Three Bedroom Apartment
- One Bathroom + Separate WC
- Offering 1034 Sq Ft (96 Sq M) Of Internal Space
- Generously Sized
- Third Floor (with lift) Of A Traditional Purpose Built Building
- Recently Renewed Lease
- Double Glazing Throughout
- Viewings Highly Recommended



Allingham Court,
Haverstock Hill,
Belsize Park, NW3

Allingham Court,
Haverstock Hill, NW3

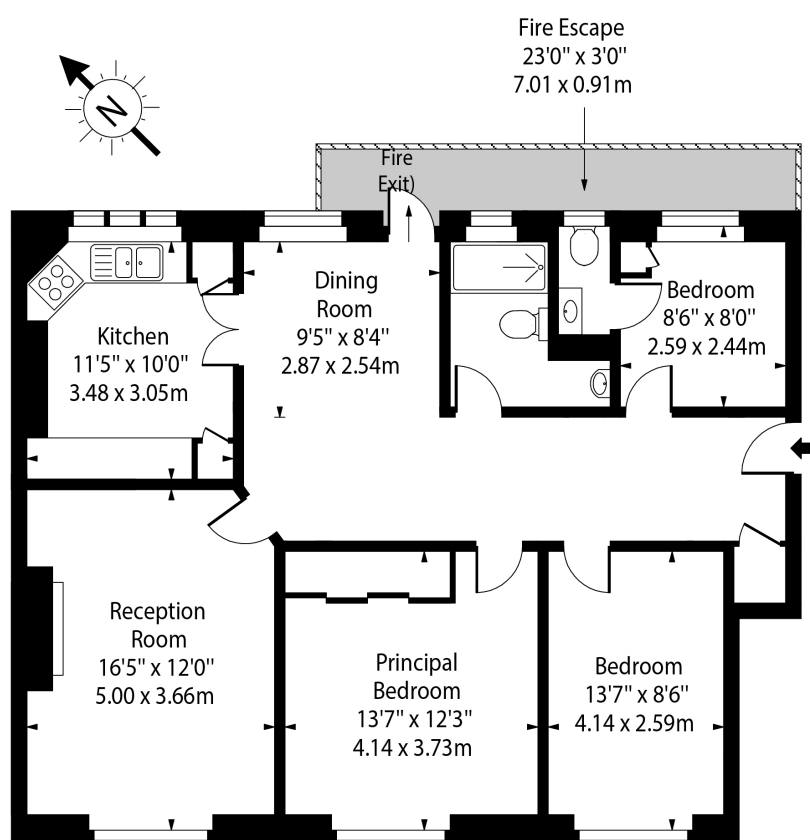

Third Floor

Approx Gross Internal Area 1034 Sq Ft - 96.06 Sq M

For Illustration Purposes Only - Not To Scale Floor Plan by www.nogaphotostudio.com Ref: No.42422

This floor plan should be used as a general outline for guidance only. Any intending purchaser or lessee should satisfy themselves by inspection, searches, enquiries and full survey as to the correctness of each statement. Any areas, measurements or distances quoted are approximate and should not be used to value a property or be the basis of any sale or let.