



Parkhill Road, Belsize Park, NW3

£750
p/w



Parkhill Road, Belsize Park, NW3

A superb and generously proportioned 3 bedroom, 2 bathroom apartment benefiting from a delightful private rear garden and it's own entrance.

This smartly designed apartment boasts 1092 sq ft (101 Sq M) including a spacious 17ft x 15ft reception room, a modern and fully fitted kitchen and an extensive 13ft x 11ft master bedroom with en-suite and direct access to the rear garden. Further key features include an expansive 15ft x 12ft second bedroom with en-suite attached, a study/third bedroom and a separate WC.

Parkhill Road is perfectly situated just 0.4 miles from Belsize Park Underground station (Northern Line) and the local amenities found on Haverstock Hill. Further local amenities, cafes and restaurants can be found on England's Lane (0.2 miles from the apartment).

Features

- Garden Apartment
- 3 Bedrooms
- 2 Bathrooms
- Offered Unfurnished
- Private Entrance
- Extremely Well Located
- Available Now
- Separate WC
- 0.4 Miles From Belsize Park Underground

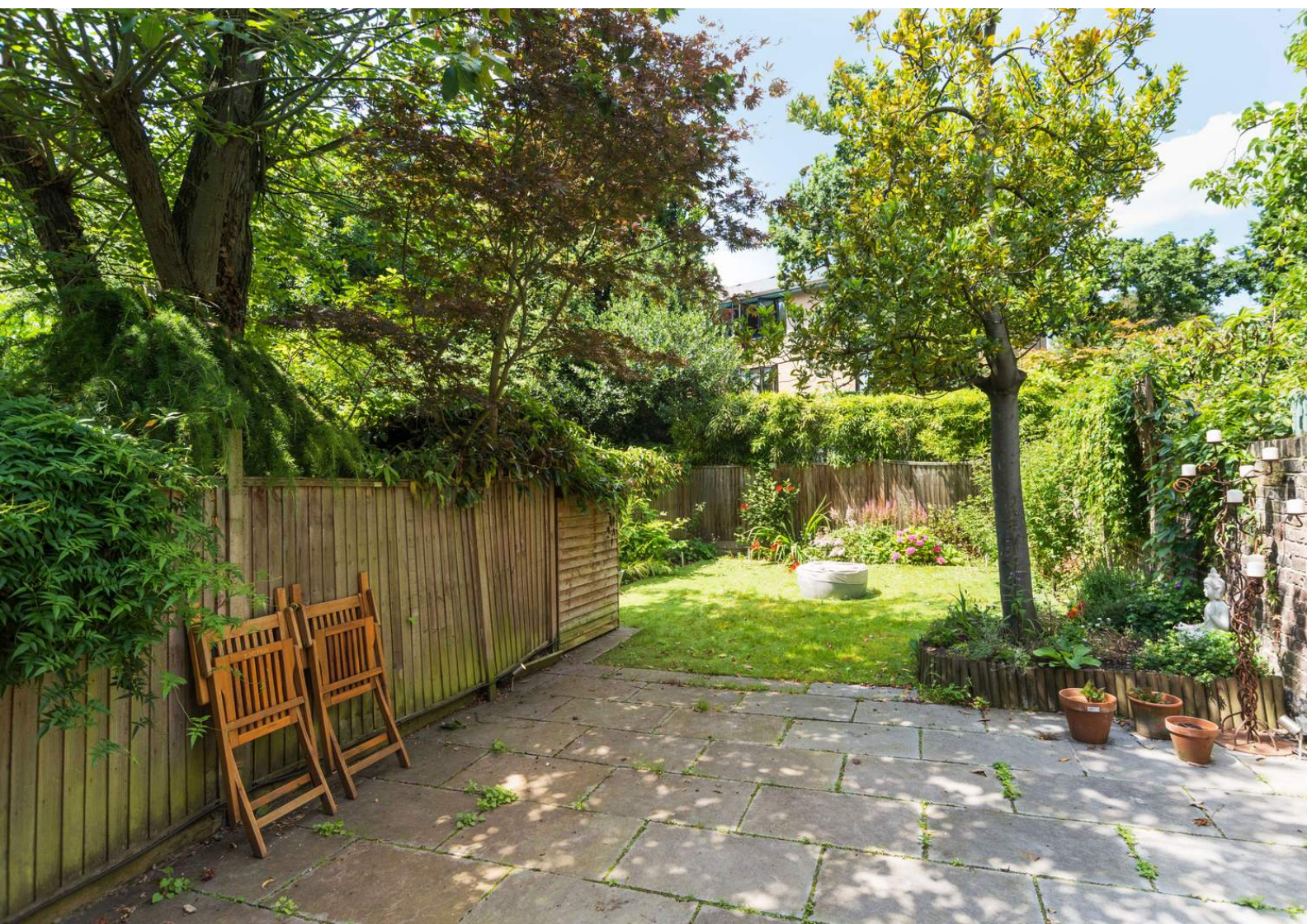

Parkhill Road, Belsize
Park, NW3

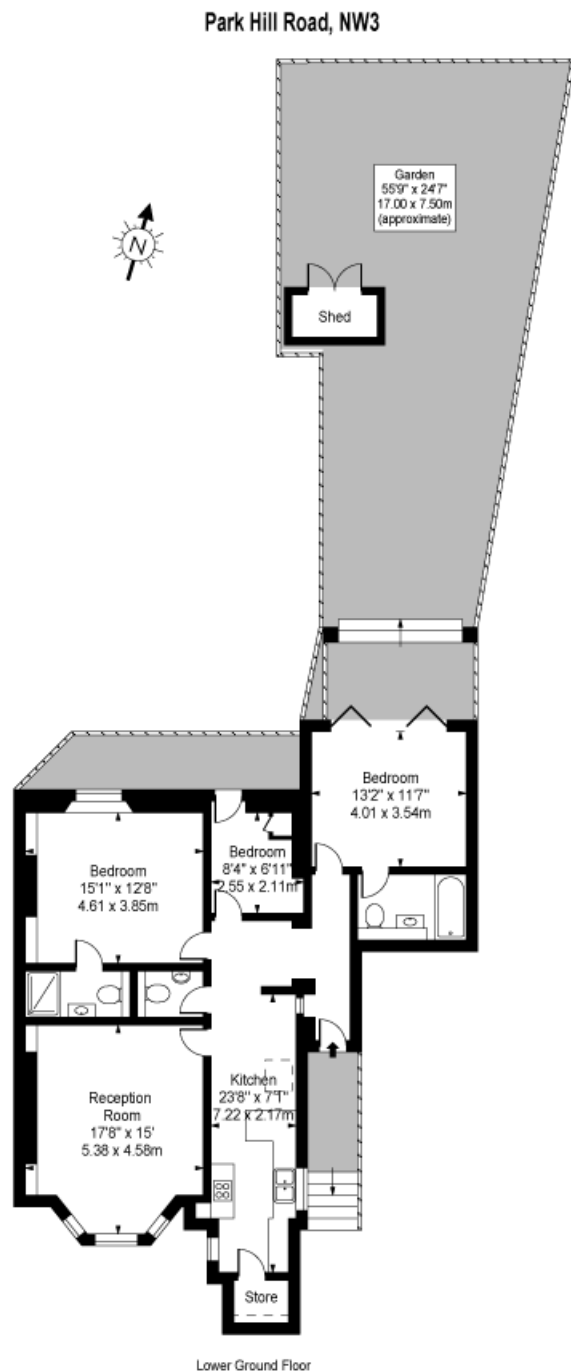

For Illustration Purposes Only - Not To Scale Floor Plan by www.nogaphotostudio.com Ref: No.39283

This floor plan should be used as a general outline for guidance only. Any intending purchaser or lessee should satisfy themselves by inspection, searches, enquiries and full survey as to the correctness of each statement. Any areas, measurements or distances quoted are approximate and should not be used to value a property or be the basis of any sale or let.