



Byron Mews, London, NW3

£750,000



Byron Mews, London, NW3

Quietly positioned within this secure gated Mews, a stylish two double bedroom, two bathroom top floor apartment benefiting from an allocated covered parking space.

This well-proportioned home offers a bright and expansive 14ft reception room with a modern and fully fitted kitchen attached, a spacious master bedroom with en-suite and built in wardrobes and a further double second bedroom. Additional key features include an allocated covered parking space and a share of the freehold.

Byron Mews is superbly located with the local amenities on South End Road and Hampstead Heath overground station just yards away along with access to the popular Hampstead Heath. Belsize Park underground station (Northern Line) and the shops on Rosslyn Hill are also positioned close by.

Features

- Gated Development
- Allocated Covered Parking Space
- Two Double Bedrooms
- Two Bathrooms
- Top Floor
- Share Of Freehold
- Quietly Located
- Local Amenities & Transport Links Close By



Byron Mews, London, NW3

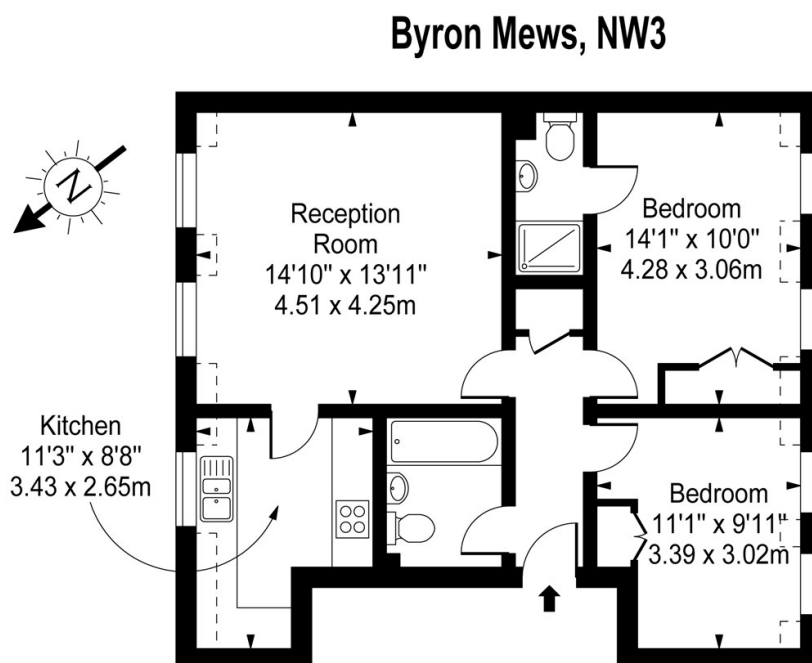

Second Floor

Approx Gross Internal Area **667 Sq Ft - 61.94 Sq M**

Approx Floor Area Including Restricted Heights **691 Sq Ft - 64.19 Sq M**

For Illustration Purposes Only - Not To Scale Floor Plan by www.nogaphotostudio.com Ref: No.38063

This floor plan should be used as a general outline for guidance only. Any intending purchaser or lessee should satisfy themselves by inspection, searches, enquiries and full survey as to the correctness of each statement. Any areas, measurements or distances quoted are approximate and should not be used to value a property or be the basis of any sale or let.